



Skyliner® Technical Bulletin 011:
Skyliner® SkyHook™ for Walls

The Skyliner® Fabric System is provided with Sky Hook (or Insul-Hold HD Insulation Hangers) for the times when a building is using the liner system on the walls. The hanger is used to assist in preventing the insulation from sliding down the girt cavity. One box of hangers (82 pieces) is provided for every thousand square feet. The Sky Hook is 24" tall, and one should be placed approximately every thirty-six inches down the length of the building. They can be secured in place with a fastener (not supplied) or merely hooked between the girt and wall sheet. Great care should be made during installation to not push the hanger arrow too deep in the insulation so as it continues through the liner fabric.

<u>Girt Spacing</u>	<u>Hanger Length</u>	<u>Number of Arrows</u>
Up to 24"	N/A	N/A
25" to 60"	24"	2
61" to 96"	24" or 48"	2 or 4 (or 2 hangers, if necessary)

Narrow girt spacings do not require Sky Hook™ hangers.
 Sky Hook™ comes in boxes of 82 pieces for easy dispensing.
 Arrows are spaced 8" apart and bend out approximately 3".
 All above dimensions are approximate.

**Questions? Contact your Bay District Manager,
 call 844.999.7153 or visit www.SkylinerSystems.com.**

**How to Use Sky Hook™ in
 Wall Applications**

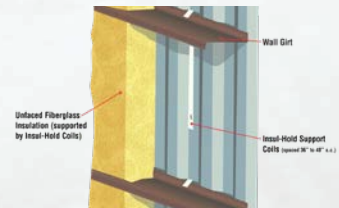

Step 1: From the interior of the building, slide a Sky Hook between the girt and sheeted wall panel allowing the end to extend past the girt lip approximately 1½". Bend the extended part inward around the girt lip to secure OR, if desired, the Sky Hook can be secured with a fastener (not supplied).

For larger girt spacing, two Sky Hook hangers can be used, if necessary, by the aforementioned process with an additional Sky Hook attached to the upper one by bending the tab out of the lower and hanging it in the square hole of the upper.

Step 2: Bend the arrows toward the interior of the building.

Step 3: Cut fiberglass insulation to girt dimension and place in-between girts, impaling the insulation on the extended arrows.

(Photo of Actual fabric)